



HARVEY ROBINSON

£375,000

Bloomfield Drive

Huntingdon, PE29 6LD

PROPERTY SUMMARY

Harvey Robinson Estate Agents in Huntingdon are delighted to offer for sale this Four Bedroom End of Terrace Townhouse located in the popular area of Hinchingsbrooke. The current owner has made many improvements such as the addition of a garden office, upgraded kitchen and patio in the garden. The property briefly comprises of Entrance Hall, Cloakroom, Lounge, Kitchen/Diner, Four Bedrooms with Ensuite To Master, Family Bathroom, Enclosed Rear Garden, Driveway Parking and the addition of an external office. For more information and to arrange a viewing please contact Harvey Robinson Estate Agents in Huntingdon.





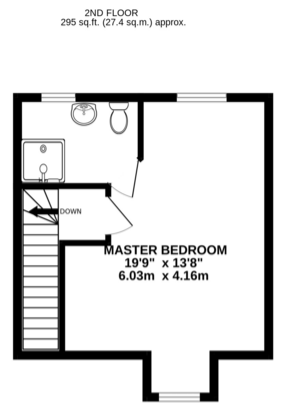
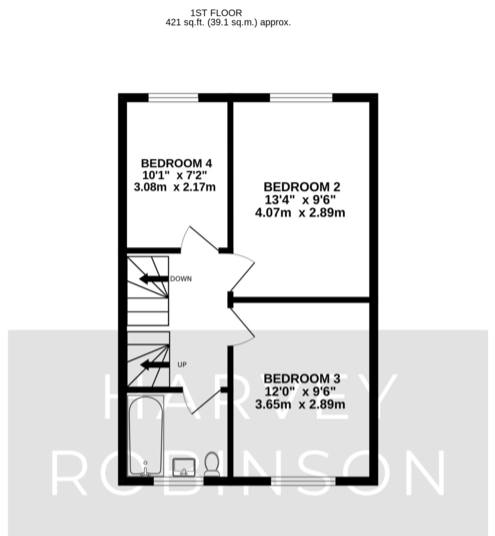
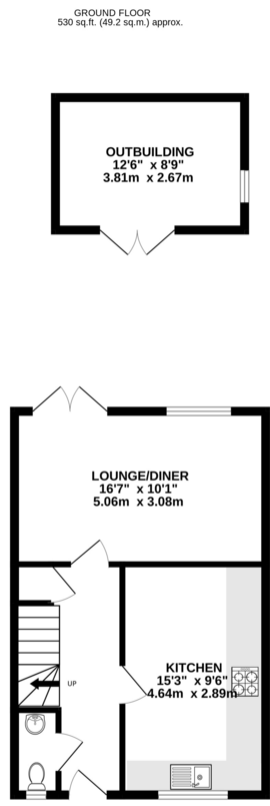

TOTAL FLOOR AREA: 1245 sq.ft. (115.7 sq.m.) approx.
Made with Metropix ©2024

FAQs

Built: 2019
 Current Owners: Owned for 4 1/2 Years
 Boundary: Rear and Right hand side as you have your back to the property
 Rear Garden: South East facing
 Water Meter: Yes, Located on Driveway
 Boiler: Installed 2019
 Loft: Boarded, Light and Ladder
 EPC: B
 Council Tax: C
 Develop: Persimon

Energy Efficiency Rating		
	Current	Potential
<i>Very energy efficient - lower running costs</i>		
(92-100) A		94
(81-91) B	85	
(69-80) C		
(55-68) D		

Agents Note: Whilst every care has been taken to prepare these particulars, they are for guidance purposes only. All measurements are approximate and are for general guidance purposes only and whilst every care has been taken to ensure their accuracy, they should not be relied upon and potential buyers/tenants are advised to recheck the measurements

HARVEY ROBINSON

OFFICE ADDRESS

91 High Street, Huntingdon,
Cambridgeshire, PE29 3DP

CONTACT

01480 454040
 huntingdon@harveyrobinson.co.uk
 www.harveyrobinson.co.uk