



£220,000

7 Barleyfield Way

Huntingdon, PE29 1DD

PROPERTY SUMMARY

Harvey Robinson Estate Agents in Huntingdon are delighted to offer For Sale this Two Double Bedroom End Terraced Home. Located in the heart of Huntingdon within a short distance to Huntingdon's Town Centre, Mainline Station, Bus Station as well as being within close proximity to Primary and Secondary School's as well as Huntingdon Regional College. Built by Linden Homes in 2015 with a 10 year NHBC warranty. The property has many other benefits including it being well presented throughout, two double bedrooms, cloakroom, allocated parking, as well as a visitor bays, enclosed rear garden, UPVC double glazing throughout and gas central heating. This property would make an ideal first time buy or investment purchase. To arrange a viewing, please contact our Huntingdon Office.





GROUND FLOOR
297 sq.ft. (27.6 sq.m.) approx.

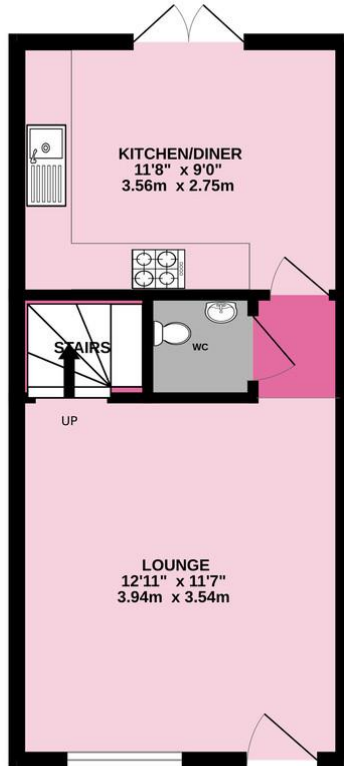

1ST FLOOR
297 sq.ft. (27.6 sq.m.) approx.

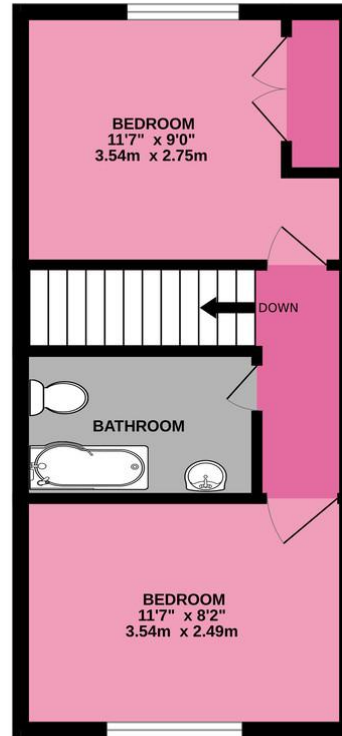

TOTAL FLOOR AREA: 595 sq.ft. (55.2 sq.m.) approx.
Made with Metroplex ©2023

FAQs

Tenure: Freehold
 Age of Property: 2015
 Developer: Linden Homes
 Maintenance Charge: £100 per 6 months
 Council Tax Band: A
 Water Meter: Yes, located at the front of the property
 Boiler: 2015
 Allocated Parking: To front of property
 What3Words Location: `///insulated.backpack.intention`
 EPC rating: B

Energy Efficiency Rating			
Score	Energy rating	Current	Potential
92+	A		96 A
81-91	B	82 B	
69-80	C		
55-68	D		
39-54	E		
21-38	F		
1-20	G		

Agents Note: Whilst every care has been taken to prepare these particulars, they are for guidance purposes only. All measurements are approximate and are for general guidance purposes only and whilst every care has been taken to ensure their accuracy, they should not be relied upon and potential buyers/tenants are advised to recheck the measurements



OFFICE ADDRESS

91 High Street, Huntingdon,
Cambridgeshire, PE29 3DP

CONTACT

01480 454040
huntingdon@harveyrobinson.co.uk
www.harveyrobinson.co.uk