

A photograph of the rear garden of a two-story brick house. On the left is a brick extension with a white door. In the center is a conservatory with white frames. The garden is paved with bricks and has a brick border with gravel. There are several potted plants, including a large green tree and a red-leafed plant. The sky is blue with some clouds.

HARVEY ROBINSON

£210,000

4 Armstrong Court
Huntingdon, PE29 1GF

PROPERTY SUMMARY

Harvey Robinson Estate Agents are pleased to bring to market this Three Bedroom Mid Terraced Home in Huntingdon. In brief, the property comprises entrance hall, kitchen/breakfast room, lounge & conservatory on the ground floor. Upstairs, you will find two large double bedrooms, a further small double bedroom, bathroom with a separate WC. Outside, you will find an enclosed rear garden with brick built storage shed and gated access to off road parking.

Benefits of this home include being partially modernised including a refitted kitchen in September 2023, a refitted bathroom & WC in November 2019, a new fuse board & complete re-wire, a replacement conservatory roof in Sept 2023 and in 2021 they added a new gas boiler with additional HIVE system.

3



1



1





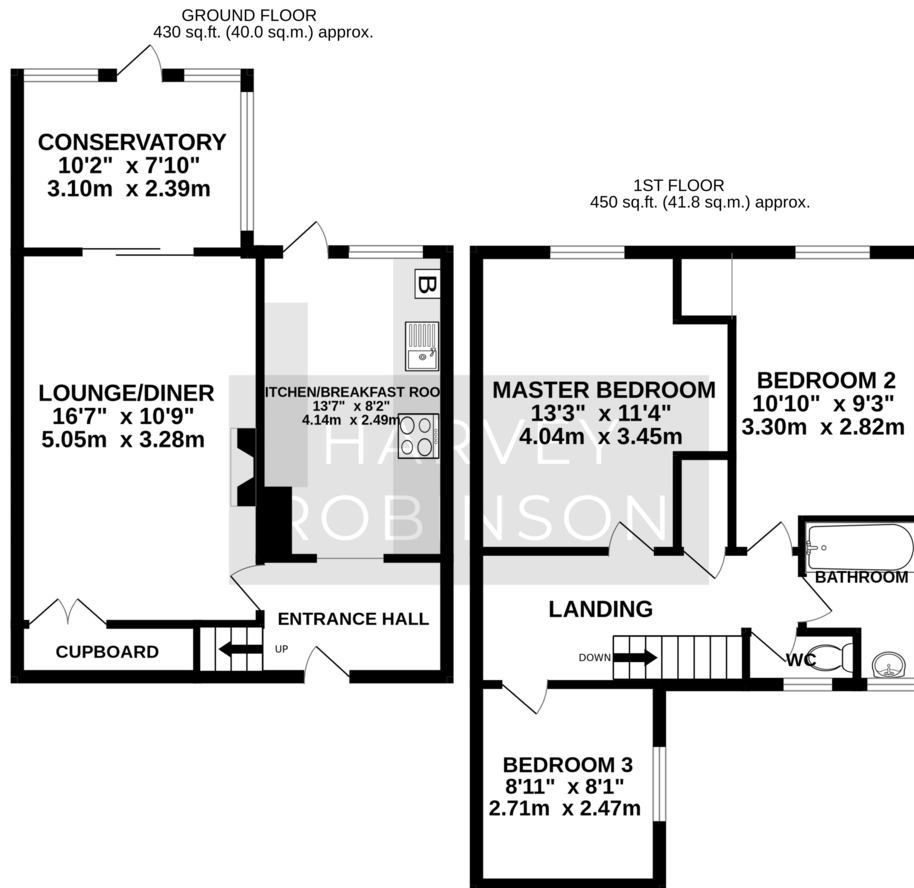

TOTAL FLOOR AREA : 880 sq.ft. (81.7 sq.m.) approx.
Made with Metropix ©2024

FAQs

Tenure: Freehold
Council Tax Band: A
Vendors Onward Chain: No chain
Age of Kitchen: Sept '23
Age of Bathroom: Nov '19
New Conservatory Roof: Sept '23
New Fuse Board: TBC

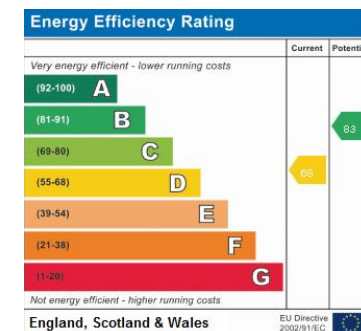

Agents Note: Whilst every care has been taken to prepare these particulars, they are for guidance purposes only. All measurements are approximate and are for general guidance purposes only and whilst every care has been taken to ensure their accuracy, they should not be relied upon and potential buyers/tenants are advised to recheck the measurements

HARVEY ROBINSON

OFFICE ADDRESS

91 High Street, Huntingdon,
Cambridgeshire, PE29 3DP

CONTACT

01480 454040
huntingdon@harveyrobinson.co.uk
www.harveyrobinson.co.uk