



HARVEY ROBINSON

Offers In Excess Of
£270,000

Haymans Way
Papworth Everard, CB23 3XL

PROPERTY SUMMARY

Harvey Robinson estate agents in St Neots are delighted to be marketing this well presented two double bedroom end of terrace home located in the sought-after village of Papworth Everard. The property is situated in a quiet cul-de-sac overlooking a small green with views over fields beyond. The property has been improved by the current owners in recent years with a re-fitted kitchen/diner and a re-fitted bathroom, the heating system has been updated and the front door and French doors to the rear have also been replaced. The accommodation comprises an entrance porch, spacious lounge, kitchen/diner, two double bedrooms and a family bathroom. Outside there is an enclosed rear garden with access to the parking area with allocated parking for 2/3 cars. Please contact our St Neots branch to arrange a viewing.





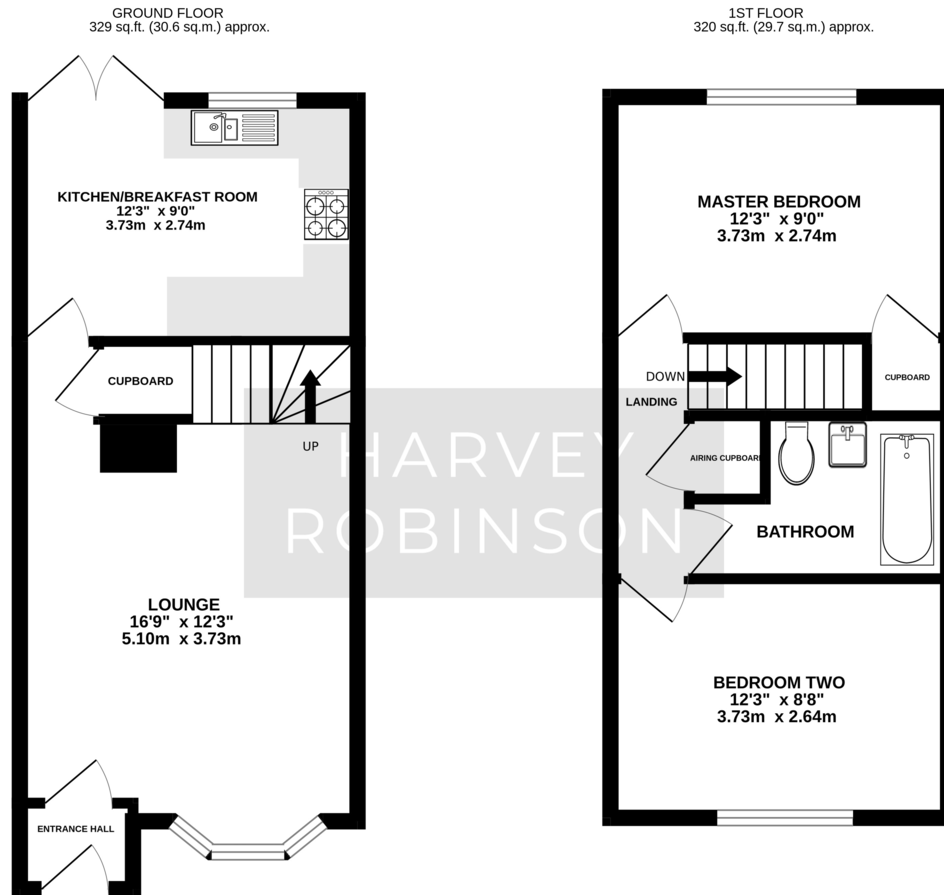

TOTAL FLOOR AREA : 649 sq.ft. (60.3 sq.m.) approx.
Made with Metroptx ©2024

FAQs

Postcode for SatNav: CB23 3XL
 What3Words Location: ///revision.only.represent
 Council Tax: C
 How long have the owners lived here: 4 years
 Reason for moving: Upsizing
 Garden aspect: East
 Boundary fence responsibility: All fences
 Water meter: Yes
 Loft: Part boarded and ladder fitted
 Primary Catchment: Papworth Pendragon
 Secondary Catchment: Swavesey village college

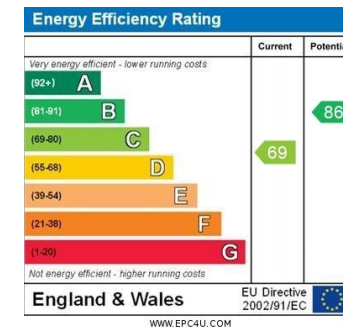

Agents Note: Whilst every care has been taken to prepare these particulars, they are for guidance purposes only. All measurements are approximate and are for general guidance purposes only and whilst every care has been taken to ensure their accuracy, they should not be relied upon and potential buyers/tenants are advised to recheck the measurements

HARVEY ROBINSON

OFFICE ADDRESS
 22 Market Square, St Neots,
 Cambridgeshire, PE19 2AF

CONTACT
 01480 454040
 stneots@harveyrobinson.co.uk
 www.harveyrobinson.co.uk