



HARVEY ROBINSON

£365,000

Holly Blue Close

Little Paxton, PE19 6TD

PROPERTY SUMMARY

Harvey Robinson estate agents in St Neots are delighted to be marketing this spacious four-bedroom townhouse located in the popular village of Little Paxton. The property offers versatile accommodation over three floors that comprises of an entrance hall, family room, and kitchen/diner to the ground floor. To the first floor there is a lounge, two bedrooms, and a family bathroom. To the second floor there are two large double bedrooms with vaulted ceilings and both benefit from en-suite shower rooms. Outside the property there is off-road parking for two cars, and an enclosed low maintenance garden.





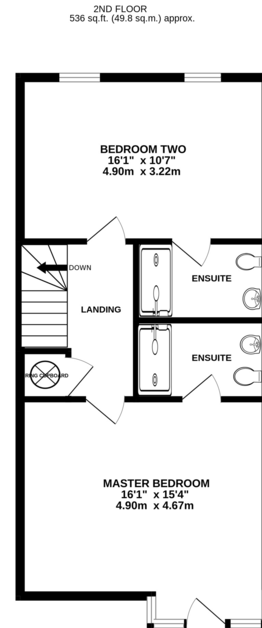
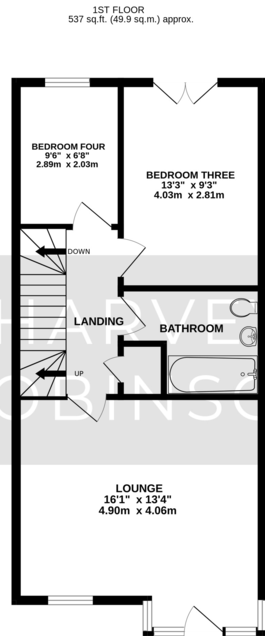
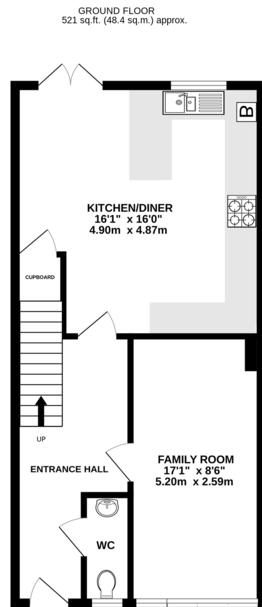

TOTAL FLOOR AREA: 1594 sq.ft. (148.1 sq.m.) approx.
Made with Metropix ©2024

FAQs

Postcode for SatNav: PE 19 6TD

What3Words Location:

///fortnight.flown.soggy

Council tax: E

How long have the owners lived here: Since 2020

When was the property built: 2013

Reason for move: Moving closer to work

Boundary fence responsibility: Left

Water meter: Yes

Boiler: Service history in place

Estate management fee: £170 per annum

Energy Efficiency Rating		
	Current	Potential
Very energy efficient - lower running costs		
(92+) A		
(81-91) B		88
(69-80) C	77	
(55-68) D		
(39-54) E		
(21-38) F		
(1-20) G		
Not energy efficient - higher running costs		
England & Wales	EU Directive 2002/91/EC	
WWW.EPC4U.COM		

Agents Note: Whilst every care has been taken to prepare these particulars, they are for guidance purposes only. All measurements are approximate and are for general guidance purposes only and whilst every care has been taken to ensure their accuracy, they should not be relied upon and potential buyers/tenants are advised to recheck the measurements

HARVEY ROBINSON

OFFICE ADDRESS

22 Market Square, St Neots,
Cambridgeshire, PE19 2AF

CONTACT

01480 454040
stneots@harveyrobinson.co.uk
www.harveyrobinson.co.uk